

# USB Class Configuration

## Introduction

In order to be able to use multiple cutters on one computer, it is necessary for the computer to differentiate all the cutters from each other.

To differentiate each cutter, there is the option to define the logical USB port.

The following options are available:

- SUMMA USB port 1
- SUMMA USB port 2
- SUMMA USB port 3
- SUMMA USB port 4
- PRINTER UNI.
- PRINTER BIDI.

The first four options can be used to differentiate the cutter from each other. Setting each cutter to another logical USB port, it is possible to connect up to four cutters to one computer using the USB interface.

The last two options are to emulate a printer. This option is usually used for sharing the cutter over a network using a printer server, or to drive the machine from a Windows printer driver (Generic/Text only). Using one of those options, it is not possible to query information from the cutter, e.g. the software cannot read the media size from the cutter.

## Procedure

Follow this procedure to set the desired USB class using the touch screen of the cutter:

1. Power off the cutter.
2. Disconnect the USB cable from the cutter.
3. Power on the cutter.
4. Press [Configuration].

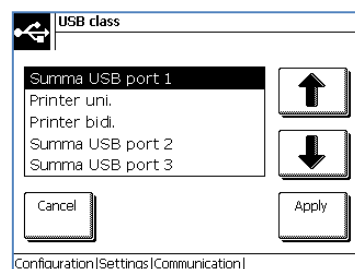
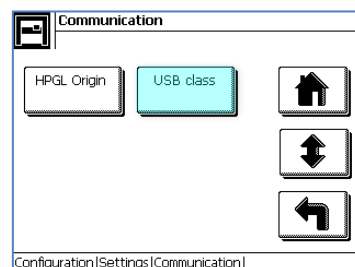
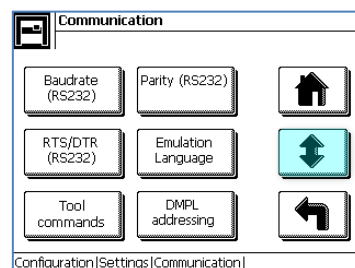
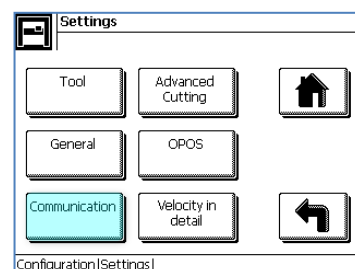
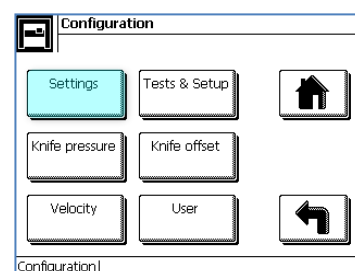
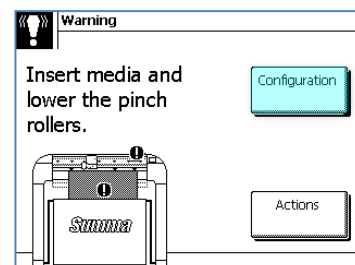

5. Press [Settings].
6. Press [Communication].
7. Scroll to the second page and press [USB Class].
8. Select the desired USB Class and press [Apply].
9. Power down the cutter.
10. Connect the USB cable to the cutter and the computer.
11. Power on the cutter.
12. The computer will detect a new device. When the chosen USB class is “Summa USB port x”, then follow the wizard to install the cutter for use with the new USB class. In case the USB interface has to emulate a printer port, then do not install a driver, Windows will then create a virtual port USB001, which can be used in a printer driver.